

Termination

WA1406 & WA1408

WA1406*: DC – 12.4 GHz

WA1408: DC – 18.0 GHz

2 WATTS



5/16" HEX

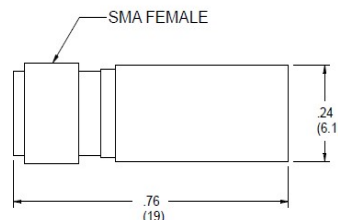
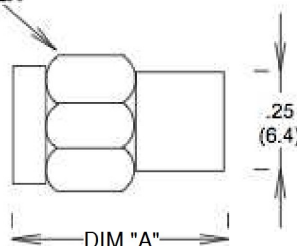

Features

Type SMA stainless steel connector per MIL-STD -348A, interface dimensions mate nondestructively with MIL-PRF-39012. Designed to meet MIL-DTL-39030 environmental specification. Compact, rugged design.

Specifications

Nominal Impedance: 50 ohms.

Frequency Range: WA1406: DC - 12.4 GHz.
WA1408: DC - 18.0 GHz.

Power Rating: 2 W maximum average rated power to 25°C ambient temperature, de-rated linearly to 10% W at 125°C. 500 W peak power (5 µsec pulse width, 0.20% duty cycle).

Temperature Range: -55°C to +125°C.

Construction: Passivated stainless steel body and connector. Gold plated beryllium copper contact. RoHS Compliant.

Calibration: VSWR performed across frequency range. Calibration test data available at additional cost.

Maximum VSWR:

Frequency (GHz)	VSWR	
	WA1406	WA1408
DC - 4.0	1.15	1.15
4.0 - 8.0	1.2	1.2
8.0 - 12.4	1.25	1.25
12.4 - 18.0	N/A	1.25

Dimensions:

Dimension	Connector Type	
	SMA (F), -1	SMA (M) -2
Length (Dim A)	19.3 (.76)	13.7 (0.52)
Weight (nominal)	1.9 (.067)	2.9 (0.1)

*WA1406 previously named WA1406A

Note: Dimensions are given in mm (in), or g (oz). Weight figure is nominal, with our standard connector configuration. Additional connector options may be available.