

OIL-FREE SCROLL VACUUM PUMPS

Scroll Meister

ISP-50



■ dimensions

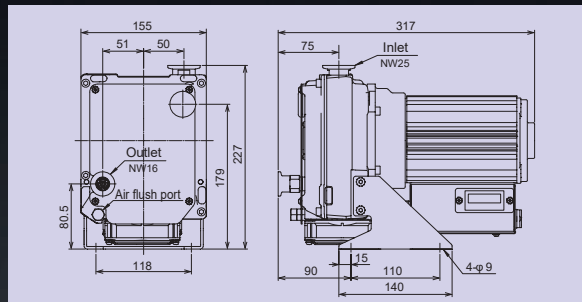

ISP-90



■ dimensions

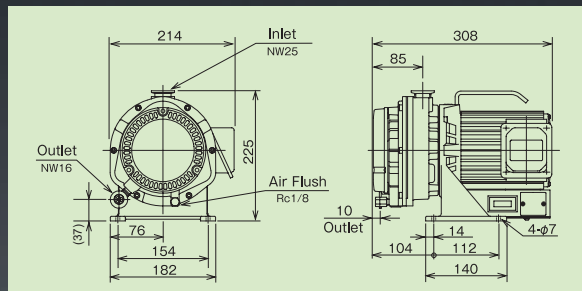

ISP-250E



■ dimensions

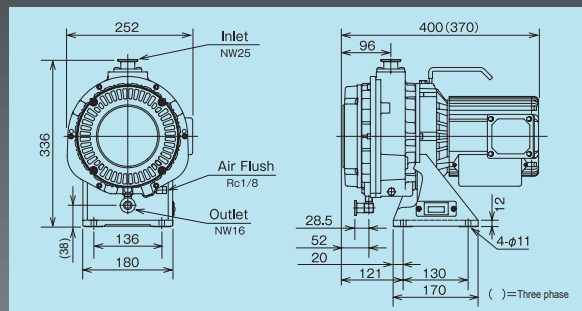

ISP-500c



■ dimensions

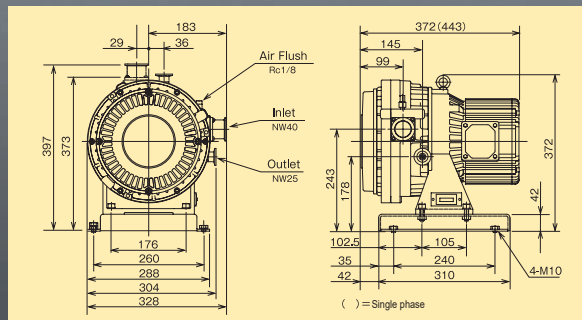

ISP-1000E



■ dimensions

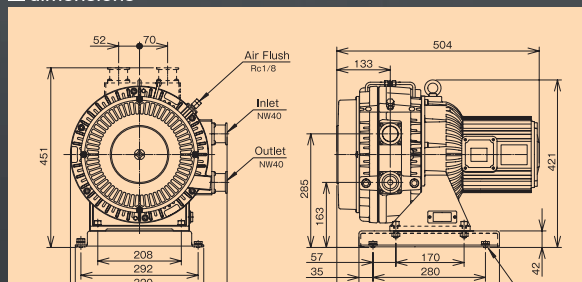

* RoHS stands for Restriction of Hazardous Substances.

RoHS is also known as directive 2002/95/EC.

* There is another NRTL Nationally Recognized Testing Laboratory that issues certifications found in the U.S. It is called CSA which originally stood for Canadian Standards Association.

* The letters "CE" are the abbreviation of the French phrase "Conformité Européenne" which literally means "European Conformity".



single-phase motor



three-phase motor



vertical inlet



horizontal inlet



RoHS conformity



CSA conformity



CCE conformity

pumping speed

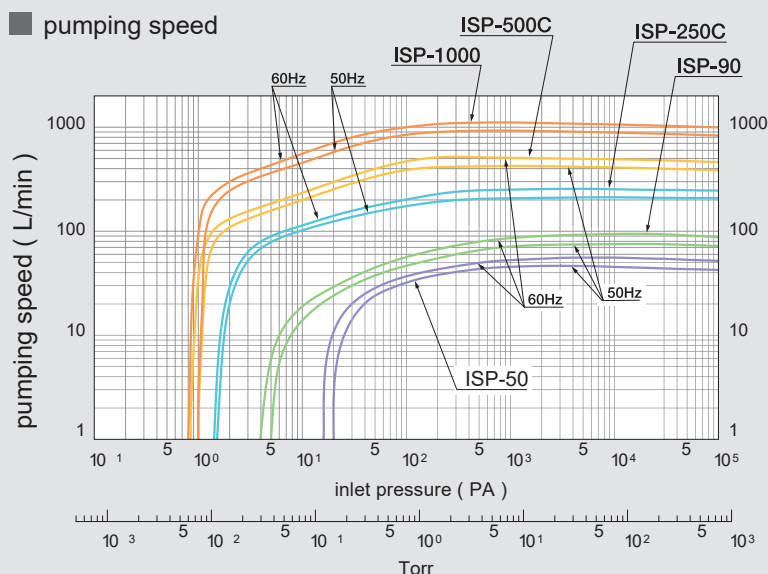

Air flushing



Air flushing

Purpose of the air flushing:
Pumping humid gas through the vacuum pump can cause condensed moisture to remain in the pump.
This remaining moisture can cause a failure of the final pressure or pump.
The air flushing process is necessary to pump out the remaining moisture.
The air flushing process also restores the final pressure.

How do you choose?

ISP-500C-T-V

500= pumping speed of vacuum pump
T= three-phase
V=vertical inlet
S= single phase
H=horizontal inlet

The model name of ISP-1000 is ISP-1000-TVA/THA.

ISP-50 is changed to ISP-50-SV1; single-phase 100 V, ISP-50-SV2; single phase 200 V.

		oil-free scroll vacuum pumps				
		ISP-50	ISP-90	ISP-250E	ISP-500C	ISP-1000E
pumping speed (50 Hz)	L/min	50	90	250	500	1,000
	m³/h	3.0	5.4	15.0	30.0	60.0
final pressure (50 Hz)		20	5	1,6	1	1
		2.0×10^{-1}	5.0×10^{-2}	1.6×10^{-2}	1.0×10^{-2}	1.0×10^{-2}
motor power	kW	0.1	0.15	0.4	0.6	1.4
voltage	single phase	AC 100 V, AC 200 V, AC 230 V				-
	three-phase	-	-	100, 115, 200, 230 (with temperature protection)		
noise level	dB (A)	48 (57 with air flushing)	52 (57 with air flushing)	58 (66 with air flushing)	60 (68 with air flushing)	67 (74 with air flushing)
weight	single phase	12	14	25	44	-
	three-phase	-	-	23	38	68
leak tightness	Pa · m³/S	$\leq 1 \times 10^{-7}$				
water vapor capacity	g/Tag	3 (with air flushing)	5 (with air flushing)	25 (with air flushing)		
air flushing	L/min	4	9	10		
inlet connection	NW	25			40	
outlet connection	NW	16			25	40
cooling system		air-cooled				
ambient temperature	°C	5~40				10~40

- The final pressure is measured as total pressure. Noise is measured in an anechoic chamber. Dimensions can be modified without prior notice if required because of design changes.

applications

Synchrotron facilities

Transport units for beamlines in synchrotron and accelerator facilities



High vacuum pumping systems

Backing pump for turbo molecular pump and mechanical booster pump



- sputtering equipment, vacuum separation systems, ion plating facilities
- gas recovery devices
- vacuum equipment
- leak detectors
- equipment handling systems

- surface modifications, electron beam processes
- vacuum furnaces, heat treatment furnaces
- use in laboratories
- vacuum packaging machines
- and more