

HydroCam Camera

CAMERA FOR REMOTE VISUAL SITE INSPECTION

Highlights

- Takes periodic snapshots of monitoring sites for remote inspection
- Easier detection of natural monitoring obstacles
- Included IR reflector for night mode and switchable day/night filter
- Remotely controllable zoom/focus lens
- Wide temperature operational range -20 °C to +60 °C

Applications

- Observation of hydrological monitoring site condition
- Maintenance planing
- Staff gauge monitoring
- Visual inspection of ice, sediment and pollutants
- Visual control for waste water tretment plants

Product Description

The Geolux HydroCam is a monitoring camera specifically designed for remote visual observation of the hydrological monitoring site. Versatile communication interfaces (RS-232, RS-485, CAN, SDI-12, Ethernet) enable easy integration with Geolux or third-party dataloggers.

Integrated switchable day/night filters and a high-quality motorized zoom/focus lens enable the Geolux HydroCam to withstand wide temperature ranges and operation in almost any environmental monitoring application.



Detailed Specifications

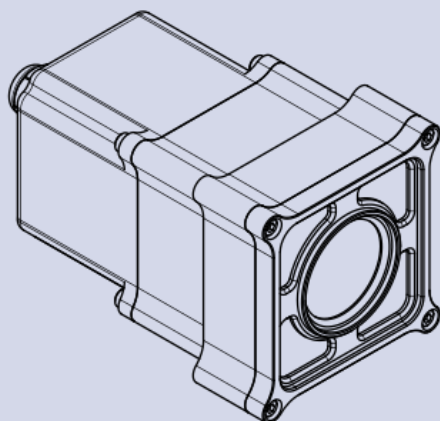
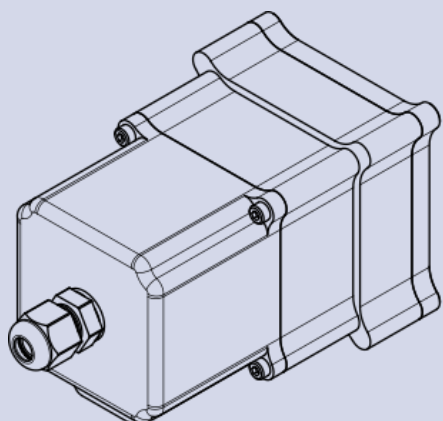

Sensor	CMOS 5Mpix 1/4"
Image Resolution	2592x1944 (Default), 2048x1536, 1920x1080, 1600x1200, 1280x960, 1024x768, 800x600, 640x480, 320x240, 160x120
Image Compression	JPEG
Optics	Motorized zoom and focus
Focal Length	6 mm to 22 mm
Field of View	46.4° to 16.3°
Minimum Illumination	0.1 lux
IR-Cut Filter	650 nm
Data Transfer	RS-232, CAN, Ethernet
Camera Control	RS-232, CAN, Ethernet, SDI-12, Modbus
Input Voltage	9 to 27 VDC
Current Consumption	75 mA (Typical), 150 mA (Maximal)
Operating Temperature	-20 °C to +60 °C
Dimension	150 x 70 x 110 mm
Weight	600 g

FCC & CE **APPROVED**

MADE IN **EU**

