



Vortex Flow Monitor Eggs DELTA II

Presenting the all-new Eggs!

The Eggs DELTA, well-received in monitoring cleaning process, coolant process, and factory air usage, has evolved.



- Easy-to-view display with orange background.
- Intuitive instantaneous flow indication with an analog display.
- Large unit display.
- Compact design with reduced height.
- Capable of fixed conversion to Normal/Standard conditions by setting temperature and pressure.



■ GENERAL SPECIFICATIONS

Item		Description			
Nominal Diameter		4mm	8mm	15mm	25mm
Flow Range (L/min)	Water	0.4 to 4	1.1 to 15	2.8 to 45	8.3 to 133
	Air	7.2 to 17	18 to 90	55 to 283	167 to 850
Connection		R male (resin), NPT male (resin), Rc female (metal)			
Construction		Indoor (non-explosionproof)			
Accuracy		Liquid: ±2% of full scale Gas: ±3% of full scale			
Maximum Operating Pressure		0.98MPa			
Fluid Temperature		-10 to +80°C			
Ambient Temperature		-10 to +60°C			
Major Parts Material		Body, sensor: PPS resin (polyphenylene sulfide) Transmitter case: Polycarbonate			
LCD Display		<div><div><ul style="list-style-type: none">• Flowrate: 7-segment, 8 digits• Unit: 16-segment, 3 digits• Battery indicator• Flow indicator (10-segment)• Information indicator• Background color: Orange</div><div><ul style="list-style-type: none">① Accumulated total flow: 8 digits② Hourly instantaneous flowrate [b1]: 5 digits③ Per-minute instantaneous flowrate [b2]: 5 digits④ Resettable total flow [C]: 7 digits⑤ Measured fluid pressure setting⑥ Measured fluid temperature setting</div><div><ul style="list-style-type: none">• Every time MODE button is pressed, the LCD displays items ① to ④ in order.• For [Temperature/Pressure compensation] model, items ⑤ and ⑥ will be displayed in addition to ① to ④.</div></div>			
Power Source	Battery Powered	Battery unit (dedicated lithium battery) Battery life: Approximately 6 years (at room temperature)			
	Externally Powered	Power source: 12 to 45VDC			
External Output	Battery Powered	Local display only	No output		
	Externally Powered (※1)	Analog output	4-20mA at 0-F.S. (Analog adjustment is available by using front buttons)		
		Alarm output	Open drain output (open collector equivalent) Allowable current: 20mA, Maximum applied voltage: 30V <ul style="list-style-type: none">• Alarm output status is displayed on LCD.• Status (switching ON/OFF) and set values of high/low alarm output are configurable by using front buttons.		
		Pulse output	Open drain output (open collector equivalent) Allowable current: 20mA, Maximum applied voltage: 30V Pulse width (Factored pulse): 30ms		
Installation location		① Free from rain and water ② Minimal temperature variation ③ No exposure to direct sunlight (equivalent to IP53)			

※1: Simultaneous output of analog and another (alarm or pulse) output is available.

■ PRODUCT CODE EXPLANATION

ITEM	PRODUCT CODE										DESCRIPTION
	①	②	③	④	⑤	⑥	⑦	⑧	⑨	⑩	
Model	F	L	M								Eggs DELTA II
Fluid Category				2							Liquid
				3							Gas
Nominal Diameter					S						4mm
					0						8mm
					1						15mm
					2						25mm
Display					-						
				1							LCD display provided
					0						No output (battery-powered)
					1						Factored pulse output
					2						Analog output
					4						High/low alarm output
Output					5						Factored pulse output + high/low alarm output
					7						Analog output + factored pulse output + high/low alarm output
						P					R male thread Material: PPS
Process Connection						N					NPT male thread Material: PPS
						S					Rc female thread Material: SCS14A
Version							D				Always "D"
Characteristic Code							0				None
							N				Normal conversion
							S				Standard conversion
							Z				Other temperature/pressure compensation

■ OUTSIDE DIMENSIONS

● R/NPT thread

Unit: mm

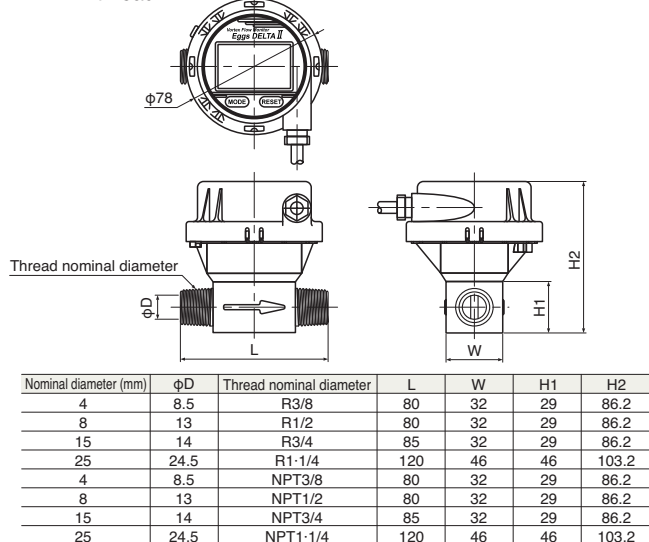

● Metal connection

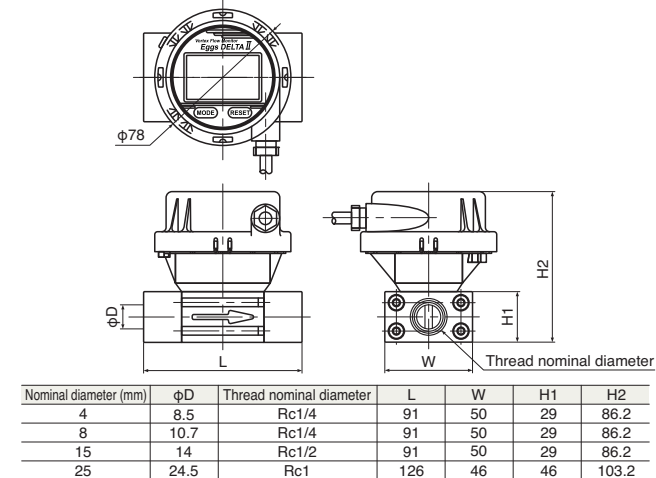

The specification as of February, 2022 is stated in this catalog. Specifications and design are subject to change without notice.



OVAL Corporation



ES France - Département Bio-tests & Industries
127 rue de Buzenval BP 26 - 92380 Garches



Tél. 01 47 95 99 90
Fax. 01 47 01 16 22



e-mail : bio@es-france.com
Site Web : www.es-france.com