

LF1 set

Near-Field Probes 100 kHz up to 50 MHz

LANGER
EMV-Technik



Short description

The LF1 near-field probe set consists of four shielded near-field probes for measuring emissions of longwave, medium wave, and shortwave frequencies on electronic devices during the development process.

The probe heads of the LF1 set are designed for the incremental detection of electromagnetic interference sources at single pins, larger components, and on assemblies. First, the electromagnetic interference of the assembly is detected by the LF-R 400 probe from up to 10 cm. Probes with higher resolution like the LF-B 3, LF-U 5 and LF-U 2.5 are then used to more precisely detect any source of interference. Our near-field probes are small and handy. They have a current attenuating sheath and, therefore, are electrically shielded. They can be connected to a spectrum analyzer or an oscilloscope with a 50 Ω input. The H-field probes do not have an internal terminating resistance of 50 Ω .

Scope of delivery

- 1x LF-R 400, H-Field Probe 100 kHz up to 50 MHz
- 1x LF-B 3, H-Field Probe 100 kHz up to 50 MHz
- 1x LF-U 2.5, H-Field Probe 100 kHz up to 50 MHz
- 1x LF-U 5, H-Field Probe 100 kHz up to 50 MHz
- 1x SMB-BNC 1 m, SMB-BNC Measurement Cable
- 1x Case 4+, System Case Near-Field Probes

Technical parameters

Frequency range	100 kHz ... 50 MHz
Connector	SMB, male, jack
Weight	200 g
Sizes (L x W x H)	(17.5 x 14 x 3.5) cm



LF1 set

Near-Field Probes 100 kHz up to 50 MHz

LANGER
EMV-Technik

Measurement set-up near field probe

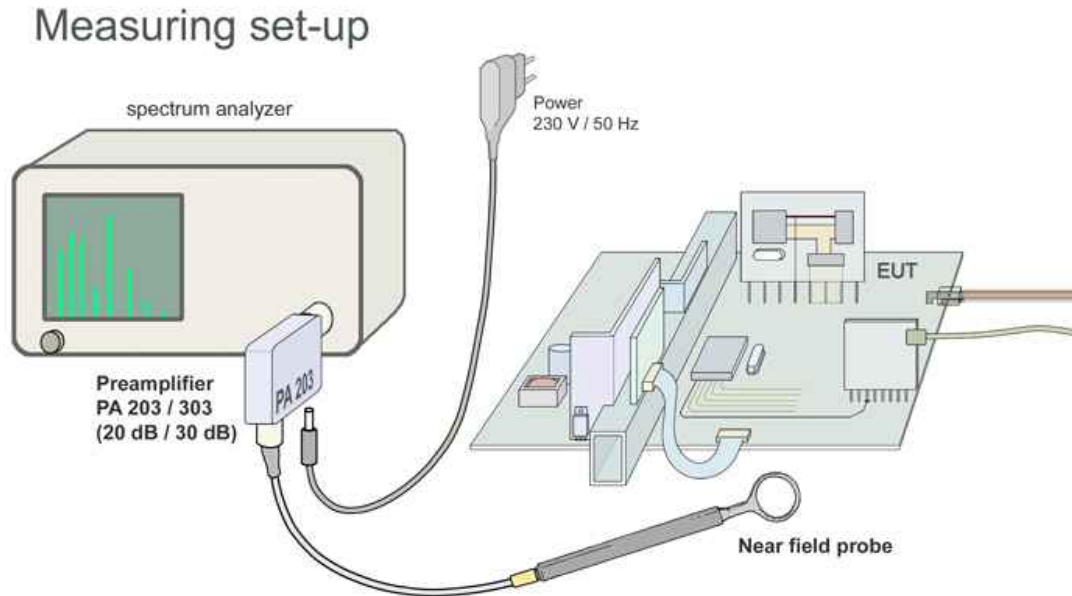

Scope of delivery

