

1U Console Drawer

1U Console LCD Drawer or Switch can save space, power and money. It only takes 1U (1.75in), same height as the rack space. It is an ideal solution for ASP, ISP, telecommunication companies, and testing rooms.

*All specifications are subject to change without notice.

What is KVM?

KVM is the acronym for keyboard, Video, Mouse. More specifically, multiple computers are connected to the KVM and controlled from a single set of keyboard, monitor and mouse. Although there are multiple computers connected the KVM, however only one can be controlled at a time. Control of each computer is done separately via the use of switches on the KVM. It does this by fooling each computer into thinking that it is currently actively connected to a separate keyboard, mouse and monitor. Since the KVM incorporates only a single set of keyboard, monitor and mouse, it saves space, cuts cost as well as increase the efficiency of work done. Along with the ease of control, it saves time and adds valuable flexibility to the whole system.

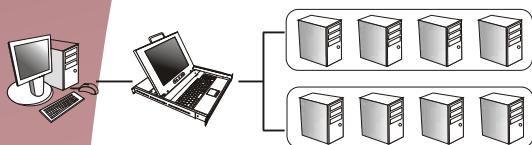

17" LDS310D-1P

Specifications

RoHS
COMPLIANT
2002/95/EC

Display Area(mm)	337.92(H)x270.34(V)(17.0-inch diagonal)
Pixel Pitch	0.264(H)x0.264(V)
Number of Pixels	1280(H)x1024(V)
Contrast Ratio	500:1
Display Color	16.2M (6bit+FRC)
Brightness(CD/m ²)	300
Backlight Unit	4 replaceable CCFLs edge-light (top/bottom)
Viewing Angle	-75~75(H); -60~75(V)(typ.)
I/O	Power: 12V DC adapter (built-in) Keyboard: PS/2 Mouse: PS/2 VGA: 15-pin D-Sub DVI-D(either ONE)
Keyboard and Key Pad	88-Key keyboard and integrated Touch Pad 17-Key numerical key pad
Power Consumption	38 Watts
Power Supply	AC 100-240V Universal
On-Screen Display	Contrast, Brightness, H/V Position, H/V Size H-scaling, Auto-adjust, Color Temp.(9300, 6500, User), Red-Gain, Blue-Gain, Green-Gain, Gamma, Recall, Phase, OSD & Exit
Hot Key Control	OSD Hot Key
Environmental Consideration	Operating temperature: 0°C~50°C (32F~122F) Storage temperature: -20°C~60°C (-4F~140F)
Humidity	10~85% in operating; 10-90% in storage
Size	544mm(D) x 483mm(W) x 44.5mm(H)

1U Console Drawer

1U Console Drawer

Mechanical Drawing

MODEL NAME:LDS310D-1P

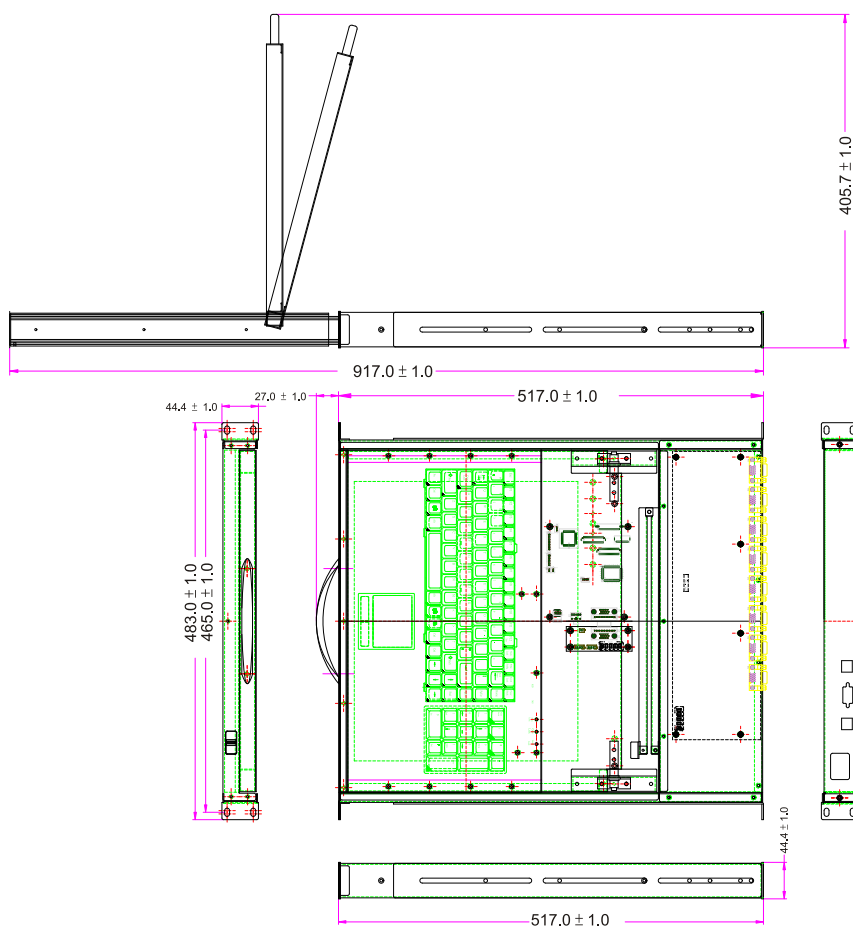

UNIT:mm

Ordering Information

		17"
KVM	1 Port	LDS310D-1P
	8 Port	LDS310D-8P
	16 Port	LDS310D-16P