

Pocket Brix–Acidity Meter (Plum) Master Kit

PAL–BX|ACID11 Cat. No. 7111

7111–E01
ATAGO®
Instruction Manual

Parts

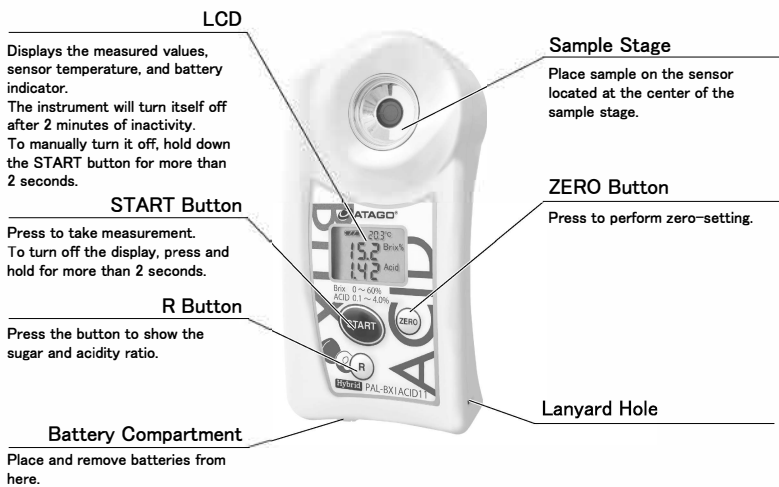

Contents

Main unit...1 Instruction Manual (this book)...1 AAA batteries...2 Plastic pipettes...5 Attachment...1
Plastic beaker...2 Digital scale...1 (About the Digital Scale)

NotePlease remove the tape in the battery compartment before first use.
MemoThe plastic pipettes are available from ATAGO.
Parts No. RE–39001 Plastic pipettes (5 pcs.)

ATAGO instruments are rigorously inspected to ensure each unit meets the highest standards of quality assurance.

Quick Tips

- The instrument measures the Brix in the sample solution, and the acidity in the 1: 50 dilution of the sample that is diluted with distilled or deionized water.
- Press the START button once to measure the Brix.
The Brix and the acidity of the sample (stock–solution) will be displayed at the end of the measurement.



- Press the ZERO button to perform zero–setting for either Brix or Acidity.
Zero–setting can be performed with water (for Brix) or air (for acidity)

- LCD Auto Shut–off
The instrument will turn itself off after 2 minutes of inactivity. To manually turn it off, hold down the START button for more than 2 seconds.

<How to use the plastic pipettes>

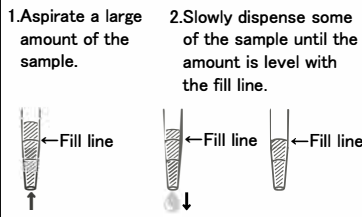

Zero–setting and Measurement

Preparation

Note Recommended on a daily basis.

Acid: Zero–setting

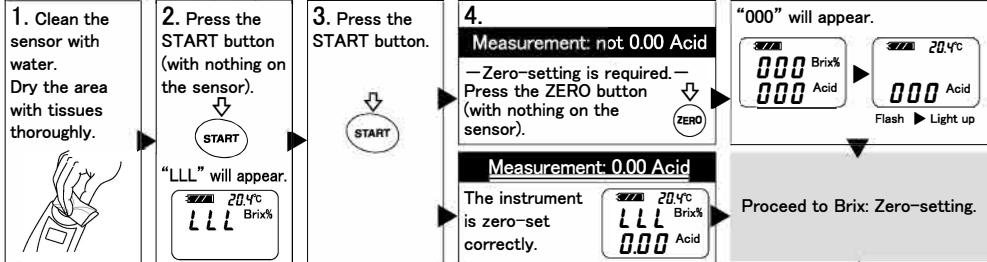

Brix: Zero–setting

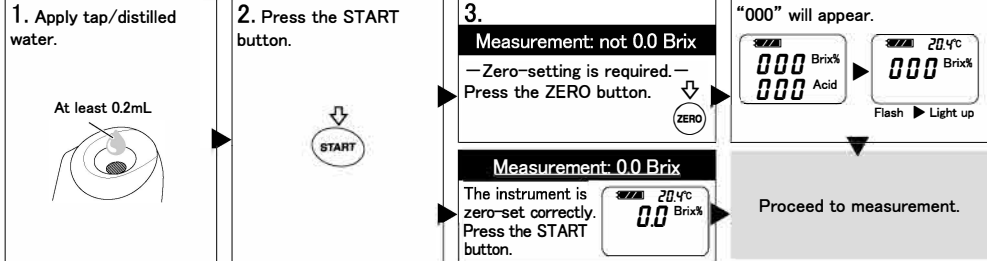

Measurement

[1]Acid: Dilution About the Digital Scale

MemoNecessary Materials
Digital scale, Plastic beaker, Plastic pipettes

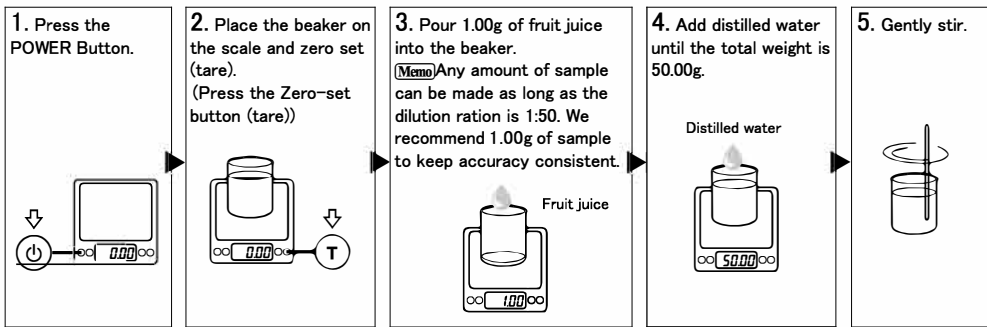

[2]Measuring the Brix

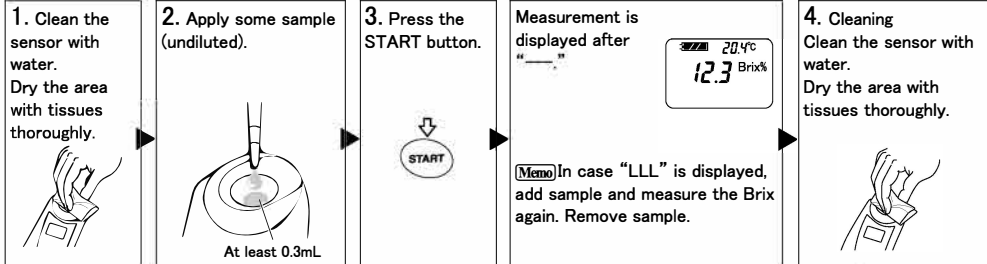

[3]Measuring the Acidity

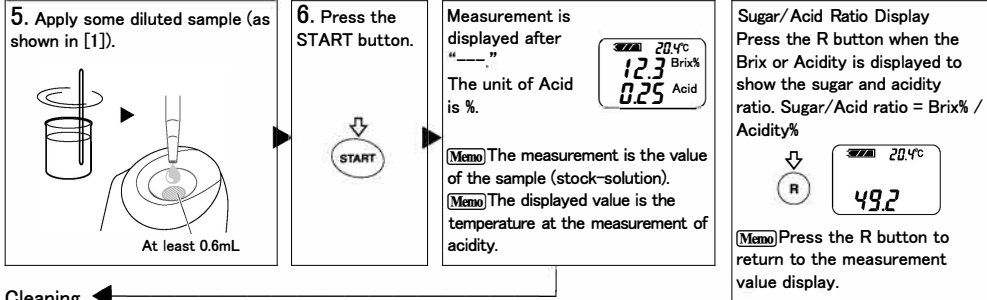

Cleaning

- Wipe off the sample. Clean the sensor with water. Dry the area with tissues thoroughly.
- Clean oily residues with mild soap, and then, rinse with water.
- Note** Handle the sensor with care so as not to scratch it.

Persistent Residue

Remove the attachment and rinse thoroughly with water.
NoteIf abnormal measurement values occur, it is likely there is residue on the attachment.

Addendum

Acid: Measuring Without using a Scale
For approximate measurement only

Measuring the Brix

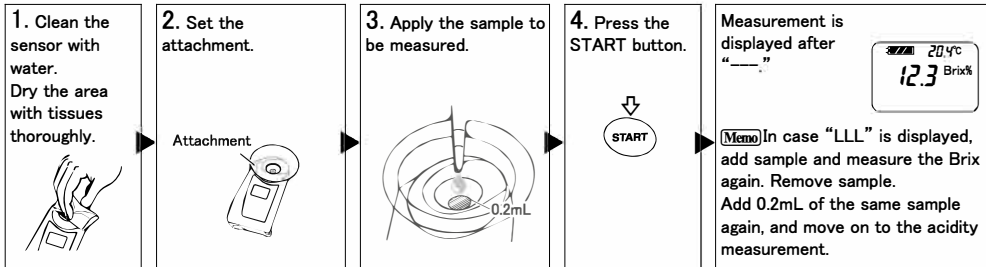

Measuring the Acidity

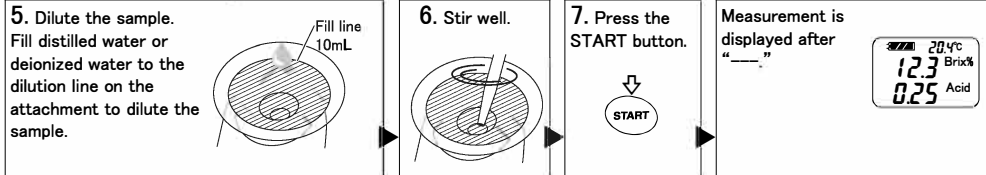

MemoA 1: 50 dilution can be prepared easily by filling the sample (stock–solution) to the line on the sample stage and filling water to the dilution line on the attachment
NoteIn case 2 lines are observed on the attachment, fill to the larger dilution line.

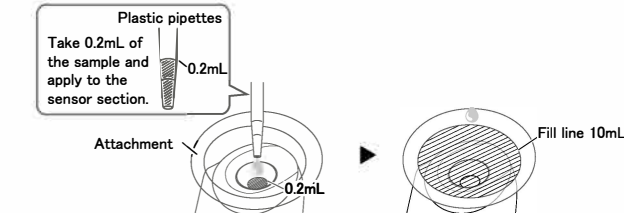

Acid: Checking with Reference Solution

When there is any doubt regarding accuracy of measurement results, adjust the reference value according to the following procedure.

MemoThe reference solution is available from ATAGO.
Parts No. RE–130004 Reference solution (0.04% Citric acid solution)

Acid: Checking with Reference Solution

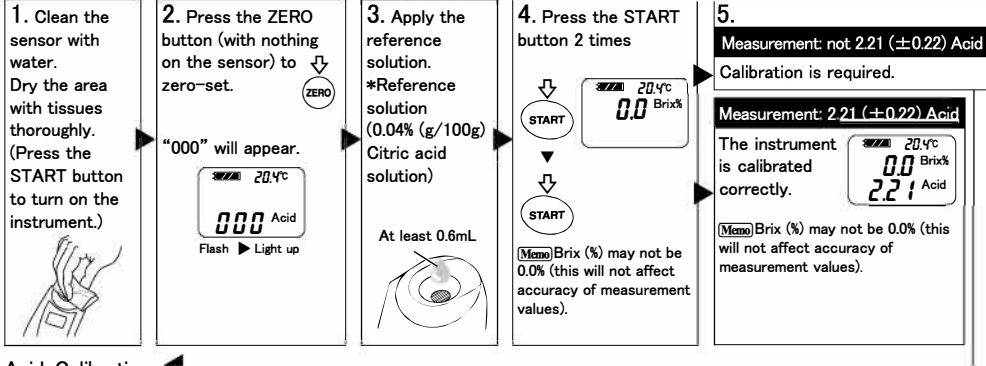

Acid: Calibration

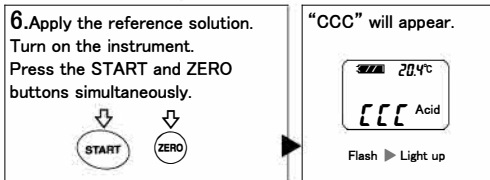

Error Messages

The following messages alert the user when an operation has failed.

- Lo** •The battery is low.
- RRR** Brix
•The ZERO button was pressed with something other than water on the sensor section.
- LLL** Brix
•The START button was pressed with nothing or an insufficient amount of sample on the sensor section.
- Sugar/Acid Ratio
•When the Sugar/Acid Ratio is unable to be calculated.
- HHH** Brix/Acid
•The sample measured outside the measurement range
- Temperature
•The sensor temperature is above the temperature range.
- Brix
•Too much light is entering the sensor, and the instrument cannot measure accurately. (Shade the sample stage with your hand and take a measurement again.)
- Sugar/Acid Ratio
•When the Sugar/Acid Ratio is unable to be calculated.

Acid: Offset Function

Discrepancies with titration

Due to the difference in measurement principles, readings from the instrument may not match up exactly with the readings by titration for certain samples.

However, correlation between the two testing methods can be seen.

Offset feature use

Create a conversion chart between the two testing methods.

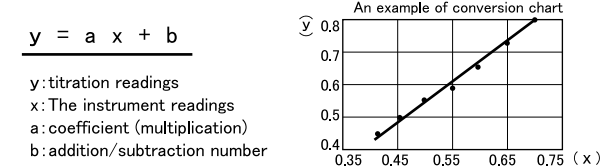

For addition/subtraction (b) [Range: -5.00 to 5.00]

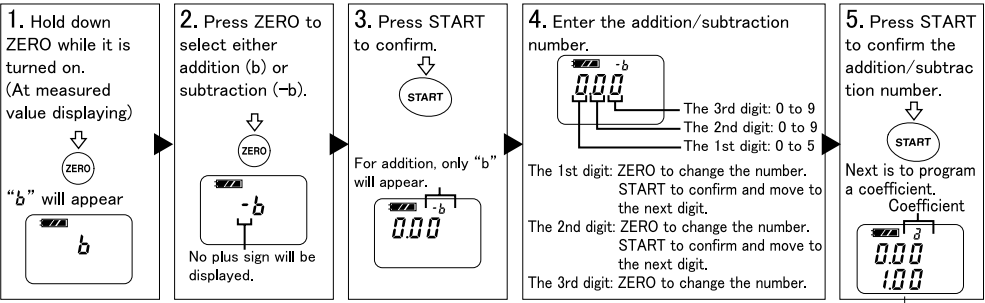

For coefficient (a) [Range: 0.50 to 5.00]

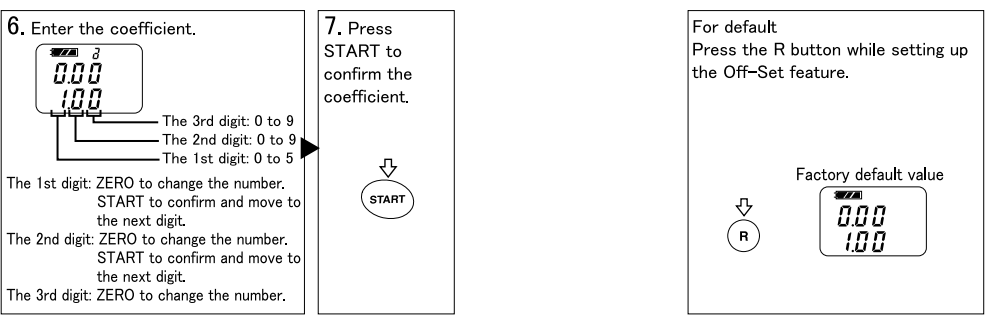

- The measurement range is shifted according to the offset settings.
- Screen images when offset is on

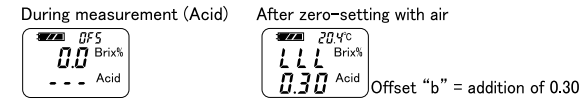

Measurement Value

Brix
Brix represents the weight of sucrose in 100 grams of sucrose solution as percentage by weight. When other dissolved solids are present in the solution, Brix conversion may be applied.
Brix is a measure of the total dissolved solids in a solution and indicates the combined concentration of all soluble substances, such as sugar, salt, protein, and acids.

Acid
This unit measures and determines the acidity through electrical conductivity.
Malic acid is the primary acid found in Plum.
The instrument measures the total acidity in a sample and converts it into malic acid concentrations.

Automatic Temperature Compensation

The Automatic Temperature Compensation (ATC) feature is based on temperature detected by the thermo sensor located near the sensor area.
ATC may not work correctly when the temperature of the sensor area is not the same as the actual temperature of the sample. When measuring a hot or cold sample, let it sit on the sensor for approximately 20 seconds and measure, or take multiple readings until measurements become stable.

Inserting Batteries

Note When the O-ring on the battery compartment cover is dirty or damaged, the water resistance may be compromised.
Lubricate the O-ring regularly.

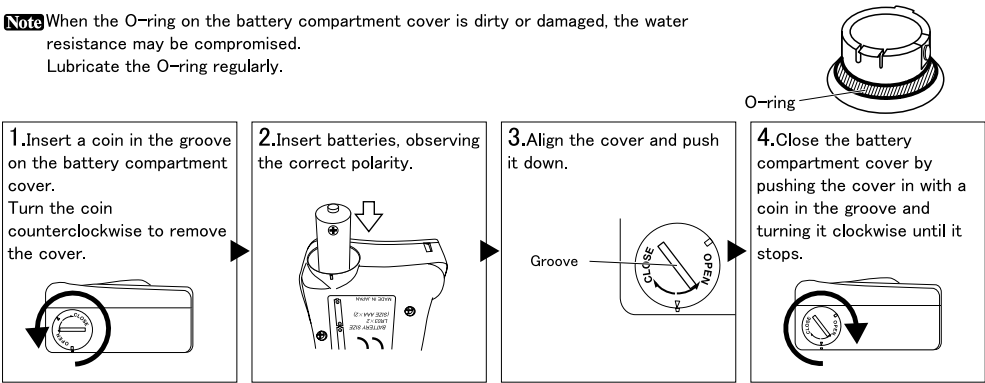

About the Digital Scale

Note Remove the tape from the battery compartment.

Contents

Main unit...1 Cover...2 (large and small) AAA batteries...2

Parts

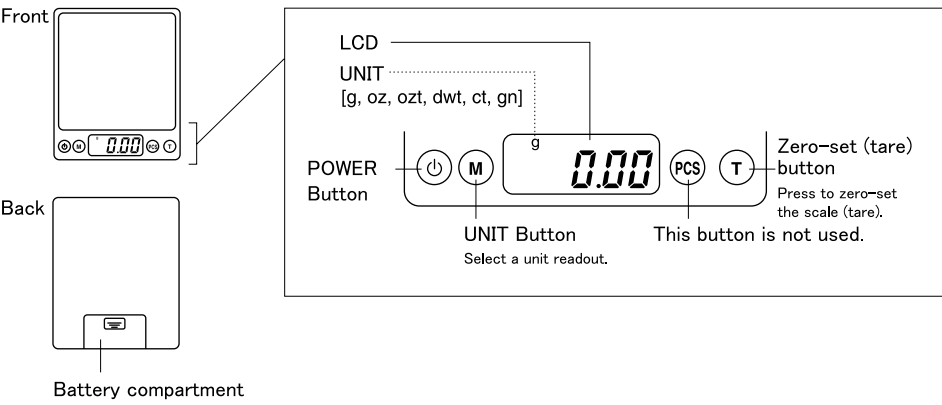

How to Use the Digital Scale

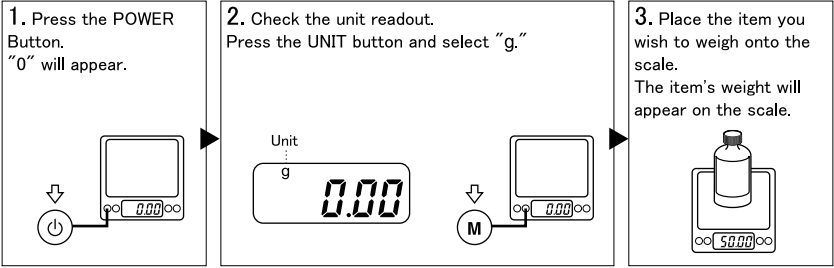

Zero-setting and Weighing

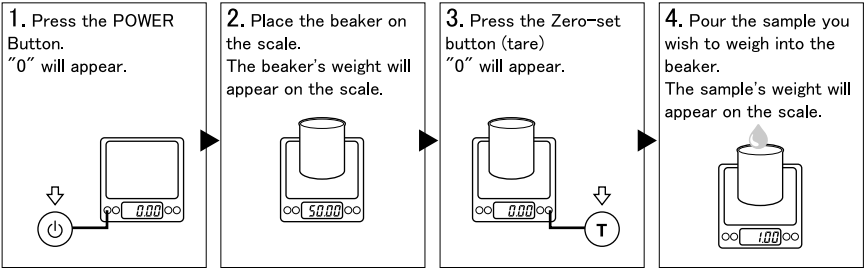

Error Messages

Lo : The battery power is low. Replace with new alkaline AAA batteries.
O-LD : The item you are trying to weigh exceeds the permissible weight limit of the scale. Quickly remove it from the scale.

Environmental conditions

- Do not expose the scale to extreme heat or cold.
- Do not expose the scale to any type of moisture.
- Use between 10 to 30°C only.
- Use in a dry, clean environment.
- Any contact with or exposure to dust, debris, humidity, strong vibrations, extreme atmospheric conditions or other electronics may affect the accuracy of the scale and result in unreliable readings.

Note

- For precise measurements, place the item you wish to weigh onto the scale gently.
- Place the scale atop a flat, stable surface.
- The digital scale is remarkably durable. However, it is a precision instrument and should be used and treated with the utmost care.
- Use of the scale for purposes other than its intended use will result in damage to its internal components.
- Do not shake or drop the scale.

Specifications

Measurement range	0.01 to 500.00g
Resolution	0.01g
Unit	g, OZ, oz t, dwt, t, gn
LCD	LCD display with backlight
Auto-Off Feature	The scale will automatically turn off after 90 seconds of inactivity.
Power supply	Two (2) AAA alkaline batteries (Do not use rechargeable batteries.)
Temperature Conditions	Ambient temperature: 10 to 30°C

Safety Precautions

Read and follow all safety instructions before operating the instrument.

WARNING

- When measuring hazardous materials, use proper safety procedures, materials, and clothing to avoid personal injury. Anyone handling hazardous materials should understand its properties and its safety requirements.
- If the instrument is dropped or subjected to a strong impact, contact your supplier for inspection.
- Do not attempt to repair, modify, or disassemble the instrument.

CAUTION

- Before use, carefully read the instruction manual and fully understand the function and operation for each part of the instrument.
- ATAGO is not liable for any loss and damage caused by the measurement and use of this instrument.
- If this instrument is used to measure highly acidic samples, the sensor section and sample stage may be damaged, resulting in inaccurate measurements.
- Do not use any metal tools when applying sample to the sensor section. The metal can damage the sensor section. If the sensor section is scratched or damaged, inaccurate measurements will occur.
- When the unit needs to be washed, use water at a temperature not exceeding 50°C.
- Only use the specified battery type. Observe proper polarities, properly aligning the anodes and cathodes.
- Do not leave the instrument in a location exposed to direct sunlight or near a heat source for any extended period of time.
- Do not change the ambient temperature of the instrument suddenly.
- Do not place the instrument where it will be subject to strong vibrations.
- Do not use the instrument where there are excessive amounts of dust.
- Do not store the instrument in an extremely cool area.
- Do not set or drop heavy objects on top of the instrument.
- Loosen the battery compartment cover for air transportation.
- The instrument is water-resistant, not waterproof, and should not be submerged.

Storage and Maintenance

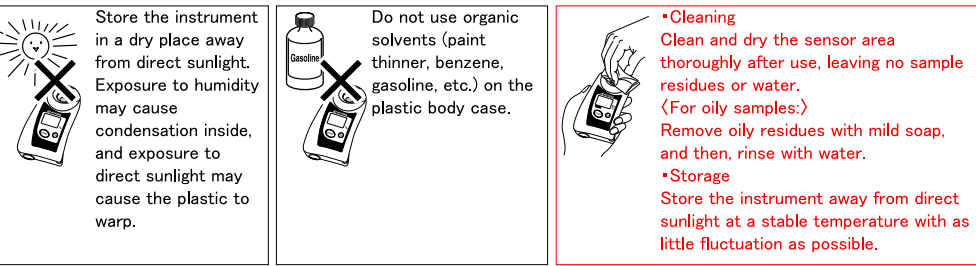

Repair and Warranty

The instrument is warranted for one year from the date of purchase.
This warranty is void if the instrument shows evidence of the following.
Send the included batteries as well if they are still in use.
•Having been disassembled by unauthorized personnel
•Damages to the sensor section and/or sample stage
•Water damage or having been dropped
•Having been misused and/or operated outside the environmental specifications
•Leakage from batteries other than those included with the unit
Repair services are available for a fee after the warranty expires.
Contact an ATAGO authorized service center for service and support.

Please have the serial number information ready when contacting a service center.

Specifications

Measurement range	Brix 0.0 to 60.0% Acid 0.10 to 4.00% 10.0 to 40.0°C	Ambient temperature range	10 to 40°C
Resolution	Brix 0.1% Acid 0.01% 0.1°C	Measurement time	Approx. 3 seconds
Measurement accuracy	Brix ±0.2% Acid ±0.10% (0.10 to 1.00%) Relative precision ±10% (1.01 to 4.00%) ±1°C	Backlight	The backlight stays on for 30 seconds after any button is pressed.
Automatic temperature compensation range	10 to 40°C	Power supply	Two (2) AAA alkaline batteries
		Battery life	Approx. 11,000 measurements (when using alkaline batteries)
		International Protection class	IP65
		Dimensions and weight	55(W) × 31(D) × 109(H)mm, 100g (main unit only)

The product is in conformity with the requirements of the EMC Directive 2004/108/EC.

ATAGO CO.,LTD.
Headquarters: The Front Tower Shiba Koen
23rd Floor 2-6-3 Shiba-koen, Minato-ku
Tokyo 105-0011, Japan
TEL: 81-3-3431-1943 FAX: 81-3-3431-1945
overseas@atago.net http://www.atago.net/

ATAGO INDIA Instruments Pvt. Ltd.
TEL: 91-22-28544915 / 40713232
customerservice@atago-india.com

ATAGO ITALIA S.r.l.
TEL: 39 02 36557267
customerservice@atago-italia.com

ATAGO THAILAND Co., Ltd.
TEL: 66-21948727-9, 66-21171549
customerservice@atago-thailand.com

ATAGO CHINA Guangzhou Co., Ltd.
TEL: 86-20-38108256
info@atago-china.com

ATAGO U.S.A., Inc.
11811 NE First Street, Suite 101,
Bellevue, WA 98005 U.S.A.

ATAGO BRASIL Ltda.
TEL: 55 16 3913-8400
customerservice@atago-brasil.com

ATAGO RUSSIA Ltd.
TEL: 7-812-777-96-96
info@atago-russia.com